

## UI Bulletin #129c

**Subject:** Rear Chassis Electrical Upfitter Connections

**Models Years:** 2016 – 2019\*

**Models:** Chevrolet Silverado  
GMC Sierra (\*old body style only)

**Origination Date:** February 17, 2016

**Revision Date:** January 29, 2020

### ADVISORY:

#### Condition/Concern:

The use of an electrical junction block at the rear of the vehicle frame has been replaced with individual connectors for the 2016 model year for the full-size LD and HD pickup trucks.

#### Repair/Recommendation:

Use the connector end views and pin-out table information in the following pages for the connectors located at the rear of the vehicle frame.

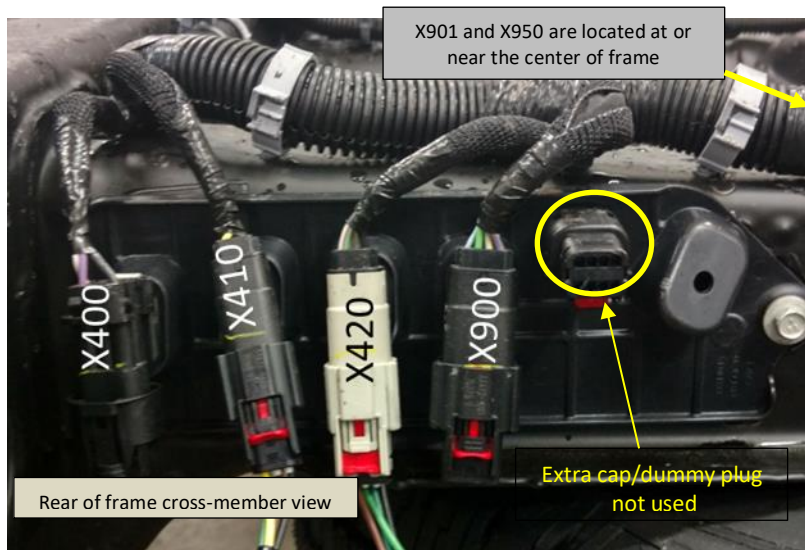

**X400 Upfitter Provision Harness to Chassis Harness**

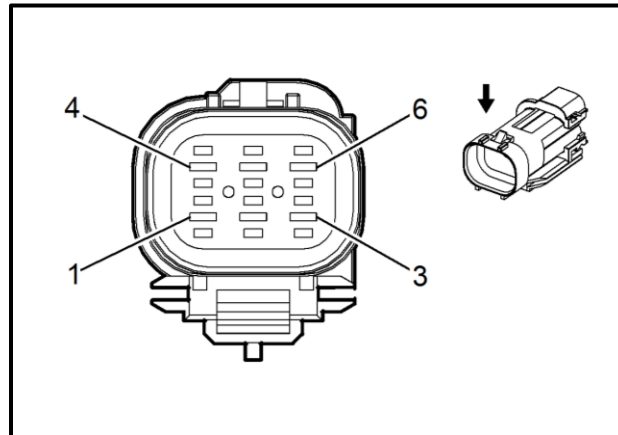

<p><b>Connector Part Information</b></p> <ul style="list-style-type: none"> <li>• Harness Type: Engine</li> <li>• OEM Connector: Not Available</li> <li>• Service Connector: Service by Harness - See Part Catalog</li> <li>• Description: 6-Way F</li> </ul>	<p><b>Connector Part Information</b></p> <ul style="list-style-type: none"> <li>• Harness Type: Chassis</li> <li>• OEM Connector: 10865189</li> <li>• Service Connector: 93185233</li> <li>• Description: 6-Way M 2.8 Series, Sealed (BK)</li> </ul>
---	--

Terminal Part Information							
Terminal Type ID	Terminated Lead	Diagnostic Test Probe	Terminal Removal Tool	Service Terminal	Tray Name	Core Crimp	Insulation Crimp
I	Not Required	Not Available	No Tool Required	Not Required	Not Required	Not Required	Not Required
II	Not Required	J-35616-5 (PU)	Not Required	Not Required	Not Required	Not Required	Not Required

X400 Engine Harness to Chassis Harness													
Pin	Size	Color	Circuit	Terminal Type ID	Option	Function	Pin	Size	Color	Circuit	Terminal Type ID	Option	
1	0.75	WH/VT	1430	I	—	Exterior Courtesy Lamp Control	1	0.75	WH/VT	1430	II	—	
4	0.5	VT/GY	1054	I	—	Stop Lamp Control	4	0.5	VT/GY	1054	II	—	
6	1	BK	1750	I	—	Ground	6	1	BK	1750	II	—	

**X410 Tail Lamp - Left Harness to Chassis Harness (Heavy Duty)**

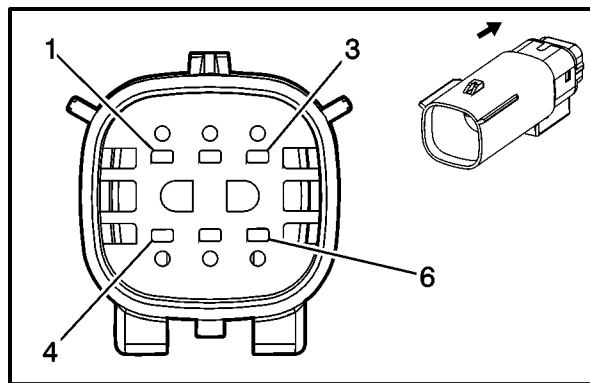

Connector Part Information	Connector Part Information
<ul style="list-style-type: none"> <li>• Harness Type: Tail Lamp - Left</li> <li>• OEM Connector: Not Available</li> <li>• Service Connector: Service by Harness - See Part Catalog</li> <li>• Description: 6-Way F</li> </ul>	<ul style="list-style-type: none"> <li>• Harness Type: Chassis</li> <li>• OEM Connector: 33171740</li> <li>• Service Connector: 19333222</li> <li>• Description: 6-Way M 150 MX Series, Sealed (BK)</li> </ul>

Terminal Part Information							
Terminal Type ID	Terminated Lead	Diagnostic Test Probe	Terminal Removal Tool	Service Terminal	Tray Name	Core Crimp	Insulation Crimp
I	Not Required	Not Available	No Tool Required	Not Required	Not Required	Not Required	Not Required
II	Not Required	J-35616-3 (GY)	Not Required	Not Required	Not Required	Not Required	Not Required

X410 Tail Lamp - Left Harness to Chassis Harness (Heavy Duty)													
Pin	Size	Color	Circuit	Terminal Type ID	Option	Function	Pin	Size	Color	Circuit	Terminal Type ID	Option	
1	0.75	YE/L-GN	18	I	—	Left Rear Stop/Turn Lamp Control	1	0.75	YE/L-GN	18	II	—	
4	0.75	L-GN/WH	24	I	—	Backup Lamp Control	4	0.75	L-GN/WH	24	II	—	
5	0.75	VT/GY	709	I	—	Left Park Lamp Control	5	0.75	VT/GY	709	II	—	
6	1.5	BK	1750	I	—	Ground	6	1.5	BK	1750	II	—	

**X410 Tail Lamp - Left Harness to Chassis Harness (Light Duty)**

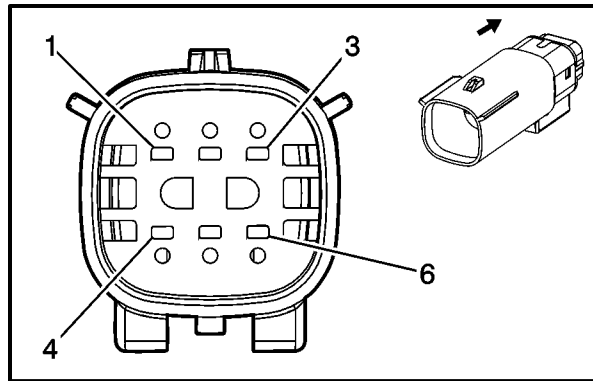

Connector Part Information
<ul style="list-style-type: none"> <li>• Harness Type: Tail Lamp - Left</li> <li>• OEM Connector: Not Available</li> <li>• Service Connector: Service by Harness - See Part Catalog</li> <li>• Description: 6-Way F</li> </ul>

Connector Part Information
<ul style="list-style-type: none"> <li>• Harness Type: Chassis</li> <li>• OEM Connector: 13950454</li> <li>• Service Connector: 13576414</li> <li>• Description: 6-Way M 150 MX Series, Sealed (BK)</li> </ul>

Terminal Part Information							
Terminal Type ID	Terminated Lead	Diagnostic Test Probe	Terminal Removal Tool	Service Terminal	Tray Name	Core Crimp	Insulation Crimp
I	Not Required	Not Available	No Tool Required	Not Required	Not Required	Not Required	Not Required
II	Not Required	J-35616-3 (GY)	Not Required	Not Required	Not Required	Not Required	Not Required

X410 Tail Lamp - Left Harness to Chassis Harness (Light Duty)													
Pin	Size	Color	Circuit	Terminal Type ID	Option	Function	Pin	Size	Color	Circuit	Terminal Type ID	Option	
1	0.75	YE/L-GN	18	I	—	Left Rear Stop/Turn Lamp Control	1	0.75	YE/L-GN	18	II	—	
2	0.5	YE/BK	5356	I	—	Left Tail Lamp Outage Detection Signal	2	0.5	YE/BK	5356	II	—	
4	0.75	L-GN/WH	24	I	—	Backup Lamp Control	4	0.75	L-GN/WH	24	II	—	
5	0.75	VT/GY	709	I	—	Left Park Lamp Control	5	0.75	VT/GY	709	II	—	
6	1.5	BK	1750	I	—	Ground	6	1.5	BK	1750	II	—	

## X420 Tail Lamp - Right Harness to Chassis Harness (Heavy Duty)

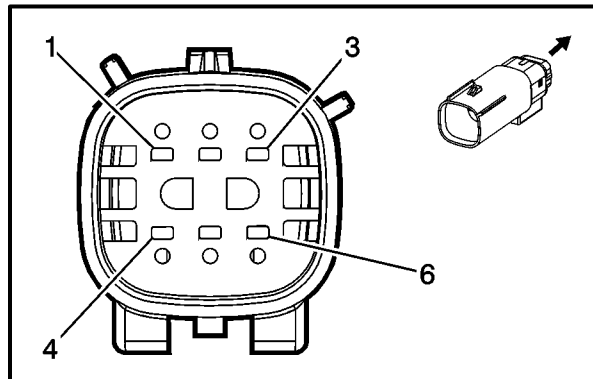

Connector Part Information	Connector Part Information
<ul style="list-style-type: none"> <li>• Harness Type: Tail Lamp - Right</li> <li>• OEM Connector: Not Available</li> <li>• Service Connector: Service by Harness - See Part Catalog</li> <li>• Description: 6-Way F</li> </ul>	<ul style="list-style-type: none"> <li>• Harness Type: Chassis</li> <li>• OEM Connector: 33171739</li> <li>• Service Connector: 19333224</li> <li>• Description: 6-Way M 150 MX Series, Sealed (GY)</li> </ul>

Terminal Part Information							
Terminal Type ID	Terminated Lead	Diagnostic Test Probe	Terminal Removal Tool	Service Terminal	Tray Name	Core Crimp	Insulation Crimp
I	Not Required	Not Available	No Tool Required	Not Required	Not Required	Not Required	Not Required
II	Not Required	J-35616-3 (GY)	Not Required	Not Required	Not Required	Not Required	Not Required

X420 Tail Lamp - Right Harness to Chassis Harness (Heavy Duty)													
Pin	Size	Color	Circuit	Terminal Type ID	Option	Function	Pin	Size	Color	Circuit	Terminal Type ID	Option	
1	0.75	GY/BN	309	I	—	Right Park Lamp Control	1	0.75	GY/BN	309	II	—	

X420 Tail Lamp - Right Harness to Chassis Harness (Heavy Duty)												
Pin	Size	Color	Circuit	Terminal Type ID	Option	Function	Pin	Size	Color	Circuit	Terminal Type ID	Option
4	0.75	L-GN/WH	24	I	—	Backup Lamp Control	4	0.75	L-GN/WH	24	II	—
5	0.75	BN/L-GN	19	I	—	Right Rear Stop/Turn Lamp Control	5	0.75	BN/L-GN	19	II	—
6	1.5	BK	2150	I	—	Ground	6	1.5	BK	2150	II	—



**X420 Tail Lamp - Right Harness to Chassis Harness (Light Duty)**

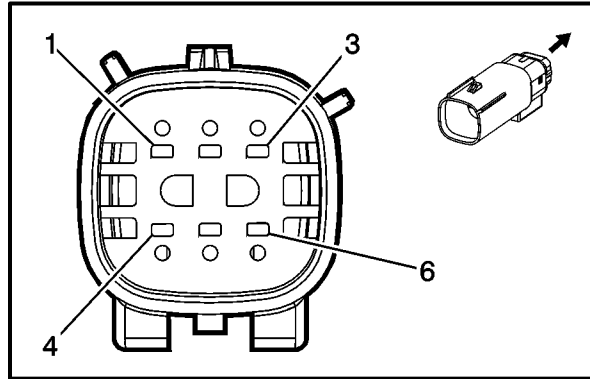

Connector Part Information	Connector Part Information
<ul style="list-style-type: none"> <li>• Harness Type: Tail Lamp - Right</li> <li>• OEM Connector: Not Available</li> <li>• Service Connector: Service by Harness - See Part Catalog</li> <li>• Description: 6-Way F</li> </ul>	<ul style="list-style-type: none"> <li>• Harness Type: Chassis</li> <li>• OEM Connector: 33162427</li> <li>• Service Connector: 19333223</li> <li>• Description: 6-Way M 150 MX Series, Sealed (GY)</li> </ul>

Terminal Part Information							
Terminal Type ID	Terminated Lead	Diagnostic Test Probe	Terminal Removal Tool	Service Terminal	Tray Name	Core Crimp	Insulation Crimp
I	Not Required	Not Available	No Tool Required	Not Required	Not Required	Not Required	Not Required
II	Not Required	J-35616-3 (GY)	Not Required	Not Required	Not Required	Not Required	Not Required

X420 Tail Lamp - Right Harness to Chassis Harness (Light Duty)												
Pin	Size	Color	Circuit	Terminal Type ID	Option	Function	Pin	Size	Color	Circuit	Terminal Type ID	Option
1	0.75	GY/BN	309	I	—	Right Park Lamp Control	1	0.75	GY/BN	309	II	—
2	0.5	VT/YE	5357	I	—	Right Tail Lamp Outage Detection Signal	2	0.5	VT/YE	5357	II	—
4	0.75	L- GN/WH	24	I	—	Backup Lamp Control	4	0.75	L- GN/WH	24	II	—
5	0.75	BN/L- GN	19	I	—	Right Rear Stop/Turn Lamp Control	5	0.75	BN/L- GN	19	II	—
6	1.5	BK	2150	I	—	Ground	6	1.5	BK	2150	II	—

## X900 Tailgate Harness to Chassis Harness

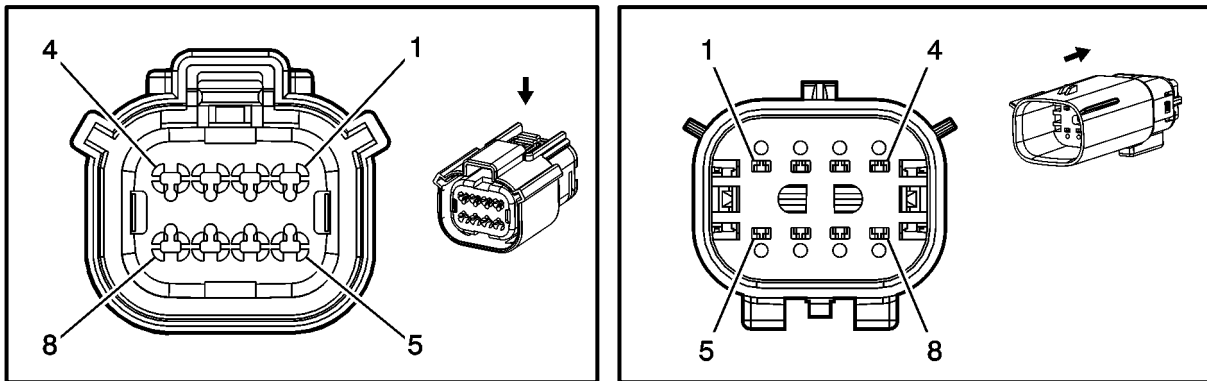

<p><b>Connector Part Information</b></p> <ul style="list-style-type: none"> <li>• Harness Type: Tailgate</li> <li>• OEM Connector: 33160350</li> <li>• Service Connector: Service by Harness - See Part Catalog</li> <li>• Description: 8-Way F 150 MX Series, Sealed (BK)</li> </ul>	<p><b>Connector Part Information</b></p> <ul style="list-style-type: none"> <li>• Harness Type: Chassis</li> <li>• OEM Connector: 15456955</li> <li>• Service Connector: 19300474</li> <li>• Description: 8-Way M 150 MX Series, Sealed (BK)</li> </ul>
---	---

Terminal Part Information							
Terminal Type ID	Terminated Lead	Diagnostic Test Probe	Terminal Removal Tool	Service Terminal	Tray Name	Core Crimp	Insulation Crimp
I	Not Required	J-35616-2A (GY)	Not Required	Not Required	Not Required	Not Required	Not Required
II	Not Required	J-35616-3 (GY)	Not Required	Not Required	Not Required	Not Required	Not Required

X900 Tailgate Harness to Chassis Harness													
Pin	Size	Color	Circuit	Terminal Type ID	Option	Function	Pin	Size	Color	Circuit	Terminal Type ID	Option	
1	0.75	GY	295	I	—	Door Lock Actuator Lock Control	1	0.75	GY	295	II	—	
2	—	—	—	—	—	Backup Lamp Control	2	0.5	L-GN	24	II	—	
3	—	—	—	—	—	Camera Signal 2 +	3	0.5	GY/YE	6972	II	—	
4	—	—	—	—	—	Run/Crank Ignition 1 Voltage	4	0.5	VT/L-GN	1739	II	—	
5	0.75	BN/YE	294	I	—	Door Lock Actuator Unlock Control	5	0.75	BN/YE	294	II	—	
6	—	—	—	—	—	Camera Low Reference	6	0.5	BK	6974	II	—	
7	—	—	—	—	—	Ground	7	0.5	BK	2550	II	—	
8	—	—	—	—	—	Camera Signal 2	8	0.5	WH/D-BU	6973	II	—	

## X901 Rear Object Alarm Sensor Harness to Chassis Harness

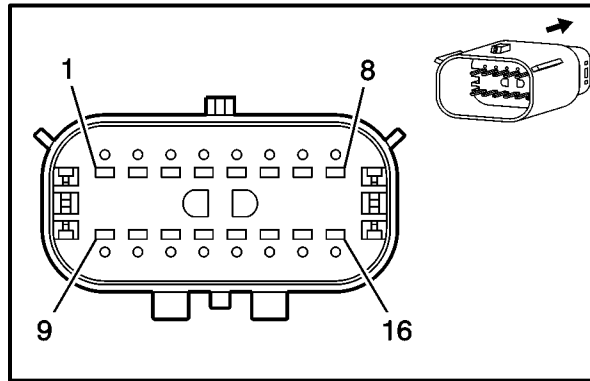

Connector Part Information	Connector Part Information
<ul style="list-style-type: none"> <li>• Harness Type: Rear Object Alarm Sensor</li> <li>• OEM Connector: Not Available</li> <li>• Service Connector: Service by Harness - See Part Catalog</li> <li>• Description: 16-Way F</li> </ul>	<ul style="list-style-type: none"> <li>• Harness Type: Chassis</li> <li>• OEM Connector: 33172365</li> <li>• Service Connector: 19300393</li> <li>• Description: 16-Way M 150 MX Series, Sealed (BK)</li> </ul>

Terminal Part Information							
Terminal Type ID	Terminated Lead	Diagnostic Test Probe	Terminal Removal Tool	Service Terminal	Tray Name	Core Crimp	Insulation Crimp
I	Not Required	Not Available	No Tool Required	Not Required	Not Required	Not Required	Not Required
II	19119440	J-35616-3 (GY)	J-38125-217	Not Available	Not Available	Not Available	Not Available

X901 Rear Object Alarm Sensor Harness to Chassis Harness													
Pin	Size	Color	Circuit	Terminal Type ID	Option	Function	Pin	Size	Color	Circuit	Terminal Type ID	Option	
1	0.75	GY/BN	309	I	—	Right Park Lamp Control	1	0.75	GY/BN	309	II	—	
2	0.75	VT/GY	709	I	—	Left Park Lamp Control	2	0.75	VT/GY	709	II	—	
3	0.5	L-GN/YE	6846	I	—	Rear License Lamp Control	3	0.5	L-GN/YE	6846	II	—	
4	0.5	L-GN/YE	6846	I	—	Rear License Lamp Control	4	0.5	L-GN/YE	6846	II	—	
6	0.5	BK/GY	2379	I	—	Object Sensor Low Reference	6	0.5	BK/GY	2379	II	—	
7	0.5	BN/WH	2374	I	—	Object Sensor Control	7	0.5	BN/WH	2374	II	—	
9	0.5	YE	2375	I	—	Left Rear Corner Object Sensor Signal	9	0.5	YE	2375	II	—	
10	0.5	YE/D-BU	2376	I	—	Left Rear Middle Object Sensor Signal	10	0.5	YE/D-BU	2376	II	—	
11	0.5	YE/RD	2377	I	—	Right Rear Middle Object Sensor Signal	11	0.5	YE/RD	2377	II	—	
12	0.5	YE/VT	2378	I	—	Right Rear Corner Object Sensor Signal	12	0.5	YE/VT	2378	II	—	
13	0.5	BK	1750	I	—	Ground	13	0.5	BK	1750	II	—	
14	0.5	BK	1750	I	—	Ground	14	0.5	BK	1750	II	—	
15	0.5	BK	1750	I	—	Ground	15	0.5	BK	1750	II	—	
16	0.5	BK	1750	I	—	Ground	16	0.5	BK	1750	II	—	

## X950 Chassis Harness to Backup Alarm Jumper (8S3 or UY2)

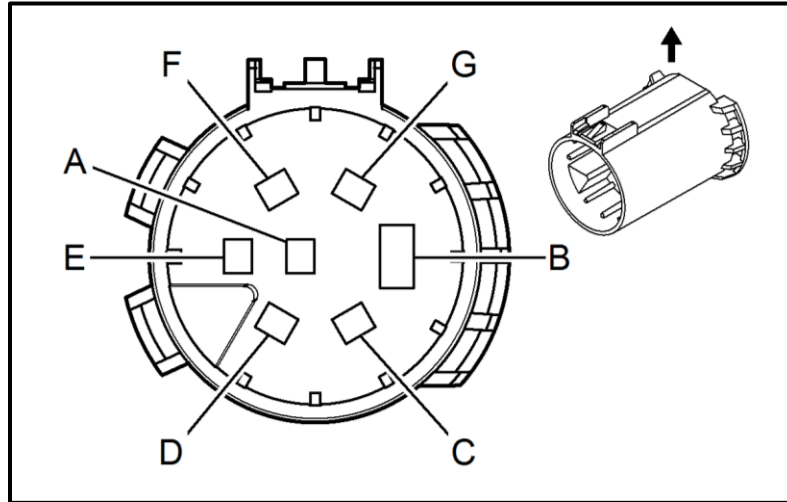

Connector Part Information	Connector Part Information
<ul style="list-style-type: none"> <li>• Harness Type: Chassis</li> <li>• OEM Connector: Not Available</li> <li>• Service Connector: Service by Harness - See Part Catalog</li> <li>• Description: 7-Way F</li> </ul>	<ul style="list-style-type: none"> <li>• Harness Type: Backup Alarm Jumper</li> <li>• OEM Connector: 15317327</li> <li>• Service Connector: Service by Harness - See Part Catalog</li> <li>• Description: 7-Way M 280 Metri-Pack Series (BK)</li> </ul>

Terminal Part Information							
Terminal Type ID	Terminated Lead	Diagnostic Test Probe	Terminal Removal Tool	Service Terminal	Tray Name	Core Crimp	Insulation Crimp
I	Not Required	Not Available	No Tool Required	Not Required	Not Required	Not Required	Not Required
II	Not Required	J-35616-43 (RD)	No Tool Required	Not Required	Not Required	Not Required	Not Required
III	Not Required	J-35616-5 (PU)	No Tool Required	Not Required	Not Required	Not Required	Not Required

X950 Chassis Harness to Backup Alarm Jumper (8S3 or UY2)													
Pin	Size	Color	Circuit	Terminal Type ID	Option	Function	Pin	Size	Color	Circuit	Terminal Type ID	Option	
G	0.75	YE/GY	1618	I	—	Left Rear Trailer Stop/Turn Lamp Control	G	0.75	YE/GY	1618	III	—	
	0.8	YE	1618		—			0.8	YE	1618		—	
F	1	BN	2109	I	—	Trailer Park Lamp Control	F	1	BN	2109	III	—	
	1.5	GY/BN	2109		—			1.5	GY/BN	2109		—	
E	3	RD/BK	742	I	—	Battery Positive Voltage	E	3	RD/BK	742	III	—	
	4	RD/L-GN	742		—			4	RD/L-GN	742		—	
D	0.75	L-GN/VT	1619	I	—	Right Rear Trailer Stop/Turn Lamp Control	D	0.75	L-GN/VT	1619	III	—	
	0.8	D-GN	1619		—			0.8	D-GN	1619		—	
C	2.5	D-BU	47	I	—	Trailer Auxiliary Control	C	2.5	D-BU	47	III	—	
	3	D-BU	47		—			3	D-BU	47		—	
B	5	WH	22	I	—	Trailer Ground	B	5	WH	22	II	—	
	6	WH	22		—			6	WH	22		—	
A	0.75	WH/L-GN	1624	I	—	Trailer Backup Lamp Control	A	0.75	WH/L-GN	1624	III	—	
	1	L-GN	1624		—			1	L-GN	1624		—	