

**SUBJECT:**

**Upfitter Integration Safety Belt & Buckle Due Care Handling**

**MODELS AFFECTED:**

**GMC Savana and Chevrolet Express Heavy Duty and Light Duty Trucks**

**MODEL YEAR(S): 2011-2015**

**DATE: 10/21/2011**

**REV. DATE: 06/06/2014**

## ADVISORY:

The purpose of this bulletin is to instruct Upfitters how to use due care when handling the safety belts and buckles in vehicles.

### **Retractor Assemblies and Buckle Assemblies**

Prior to performing any type of work on a vehicle that will create dust, particles, debris, excessive heat, paint overspray, oil or liquid residue of any kind, the safety belts and buckles, which are part of the overall safety system **MUST BE PROTECTED** while work is being done. If removed from the vehicle, parts must be clearly labeled and then stored in a safe, concealed environment.

The safety components are manufactured with close attention to detail and high quality parts and processes. Verification testing is performed on each completed assembly at the supplier and basic part functionality is confirmed at the vehicle assembly plants.

However, at the Upfitter / SVM locations, it is difficult to verify the same quality performance if the parts are exposed to varying levels of potential contamination. These safety components are not sealed and therefore, not designed to be robust in the presence of the types of contaminants listed above. The retractor assembly's vehicle sensor, webbing retraction or extraction may be affected. The buckle assembly's latch and unlatch performance may also be affected.

### **Recommendation**

To ensure that performance of the safety components is maintained, the retractor assemblies and buckle assemblies in the vehicle **MUST BE PROTECTED** until all work that would create the types of potential contamination stated above has been completed. Sample pictures are included.

If parts are removed from the vehicle they should be individually packaged and clearly labeled to indicate what vehicle they were removed from, the model year of that vehicle (i.e. 2010 vs. 2011 vs. 2012) and the seating position in the vehicle that the part was taken out of.

## Upfitter Integration Safety Belt & Buckle Due Care Handling

### PARTS THAT REQUIRE PROTECTION

IN FULL:

#### Retractor Assemblies:



#### Buckle Assemblies:

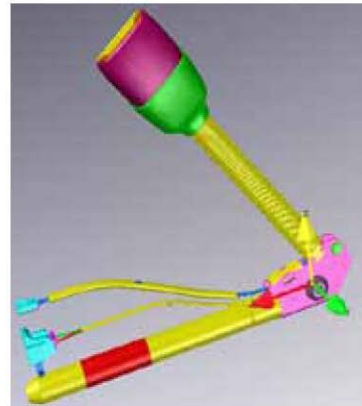
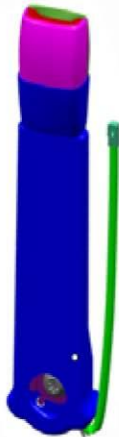

GM bulletins are intended for technicians, NOT a “do-it-to inform these technicians of some vehicles, or to provide in the proper service of a technicians have the instructions, and know-how to If a condition is described, DO applies to your vehicle, or that condition. See your GM dealer your vehicle may benefit from

use by professional yourselfer”. They are written conditions that may occur on information that could assist vehicle. Properly trained equipment, tools, safety do a job properly and safely. NOT assume that the bulletin your vehicle will have that for information on whether the information.